

Operation & Maintenance Manual



Mighty DigTM **Stump Bucket** For **Skid Steer Loaders**



Read this Manual Before Use

TABLE OF CONTENTS

| | |
|------------------------------|-------|
| SAFETY | 3-4 |
| SERIAL NUMBER/DECAL LOCATION | 5-6 |
| USER'S MOUNTING INSTRUCTIONS | 7-8 |
| OPERATING INSTRUCTIONS | 9-10 |
| ROUTINE MAINTENANCE | 11-12 |
| BOLT TORQUE INFORMATION | 13 |
| PARTS INFORMATION | 14-17 |
| GENERAL SPECIFICATIONS | 18 |
| WARRANTY | 19 |

REFERENCE INFORMATION

Write the serial number for your attachment in the spaces below. Always refer to this serial number when calling for service or parts.

Serial Number....._____

YOUR ATTACHMENT DEALER

ADDRESS:

PHONE:

CONTACT:

NOTE: *Quick Attach Attachments LLC reserves the right to make improvements in design or changes in specifications at any time without notice and without incurring any obligations to install them on units previously sold.*

SAFETY

DO NOT use or perform maintenance on this machine until this manual has been read and understood. In addition, read the Operation and Maintenance Manual(s) pertaining to the attachment and the attachment carrier (“Loader”).

The user is responsible for inspecting the machine daily, and for having parts repaired or replaced when continued use of the machine would cause damage, excessive wear to other parts or make the machine unsafe for continued operation.

If an operating procedure, tool device, maintenance or work method not specifically recommended is used, you must satisfy yourself that it is safe for you and others. You must also ensure that the attachment will not be damaged or made unsafe by the procedures you choose.

Quick Attach Attachments LLC cannot anticipate every possible circumstance that might involve potential hazard. The safety messages found in this manual and on the machine are therefore not all inclusive.

Throughout this manual, reference may be made to the left hand (LH) and right hand (RH) side. These terms are used as viewed from the operator’s seat facing front.

Call Before You Dig
1-888-258-0808



The signal words **CAUTION**, **WARNING**, or **DANGER** are used to indicate hazards.

⚠ CAUTION Indicates a potentially hazardous situation which, if not avoided, may result in minor or moderate injury.

⚠ WARNING Indicates a potentially hazardous situation which, if not avoided, could result in death or serious injury.

⚠ DANGER Indicates a potentially hazardous situation which, if not avoided, will result in death or serious injury.

The word **IMPORTANT** is used in the text when immediate damage will occur due to improper technique or operation.

The word **NOTE** is used to convey information that is out of context with the manual text; special information such as specifications, techniques, reference information, and other information of a supplementary nature.

Improper operation can cause serious injury or death.

Pre-operation

- This attachment is designed to dig out stumps, pry rocks, dig holes and trenches, and to grapple and carry material. **NEVER** use this machine for any other purpose.
- Read the operator's manual for the "Skid Steer Loader." **NEVER** allow untrained people to operate.
- Operating instructions must be given to everyone before operating this attachment and at least once a year thereafter in accordance with OSHA regulations.
- **NEVER** exceed the maximum recommended input power or speed specifications for the attachment. Over-powering or over-speeding the attachment may cause personal injury and/or machine damage.
- Keep all shields, guards, and covers in place.
- Do not modify equipment or add attachments that are not approved by Quick Attach Attachments LLC.
- Use adequate safety warning lights and devices as required by local regulations. Obey all local laws and regulations regarding machine operation on public property. Always call before you dig (1-888-258-0808). When you call, you will be directed to a location in your state/city for information about buried lines (electric, telephone, cable TV, water, sewer, gas, etc.).

Operation

- Always wear eye protection that meets ANSI z87.1 standard or use with a loader enclosure that provides similar protection.
- Hydraulic connections may be hot after use. Use gloves if connecting or disconnecting after use.
- Check and be sure all operating controls are in neutral before starting the engine.
- Keep people away from loader and attachment when in use. This attachment lifts objects and has moving parts. **NEVER** lift load directly over people – load could fall.

Operation (continued)

- To avoid electric shock or electrocution, **NEVER** operate the attachment near overhead power lines.
- **NEVER** operate near embankments or terrain that is so steep that rollover could occur.
- Always stay in the operator position when using the attachment.
- Before leaving the operators position, disengage hydraulic drive, lower the attachment to rest flat on the ground, stop engine, set park brake, and wait for all motion to stop.
- **NEVER** place hands near moving parts or clear debris while engine is running.
- **NEVER** lift people.

Avoid High Pressure Fluids Hazard



- Escaping fluid under pressure can penetrate the skin causing serious injury.
- Avoid the hazard by relieving the pressure before disconnecting hydraulic lines.
- Use a piece of paper or cardboard, NOT BODY PARTS, to check for suspected leaks. Wear protective gloves and safety glasses or goggles when servicing or performing maintenance on hydraulic systems.
- If an accident occurs, see a doctor immediately. Any fluid injected into the skin must be surgically removed within a few hours or gangrene may result.

Maintenance

- **NEVER** make adjustments, lubricate, clean, or perform any service on the machine while it is in operation.
- Make sure the attachment is serviced on a daily basis. Improper maintenance can cause serious injury or death in addition to damage to the attachment and/or your equipment.

SERIAL NUMBER AND SAFETY DECAL LOCATIONS

Serial Number Location:

It is important to refer to the serial number of the attachment when making repairs or ordering parts. Early or later models (identification made by serial number) may use different parts, or it may be necessary to use different procedures in doing a specific operation.

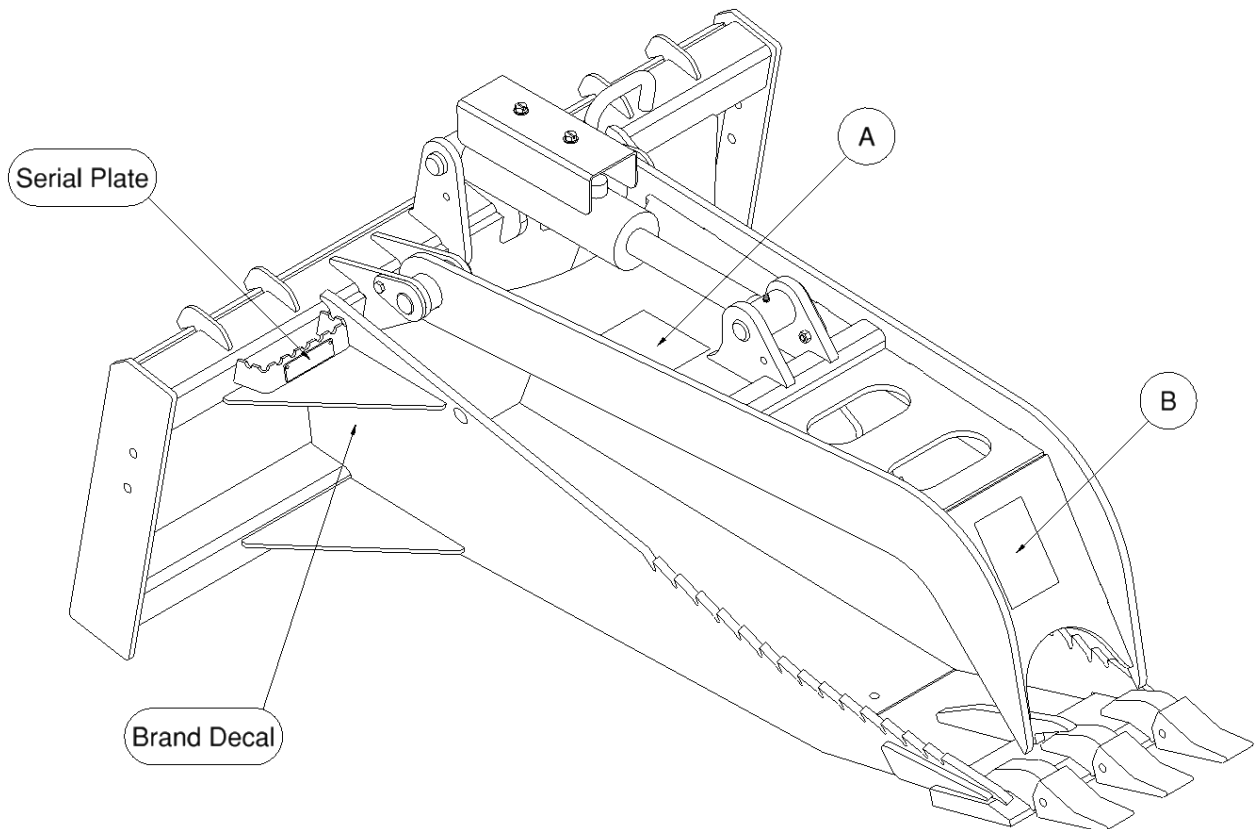
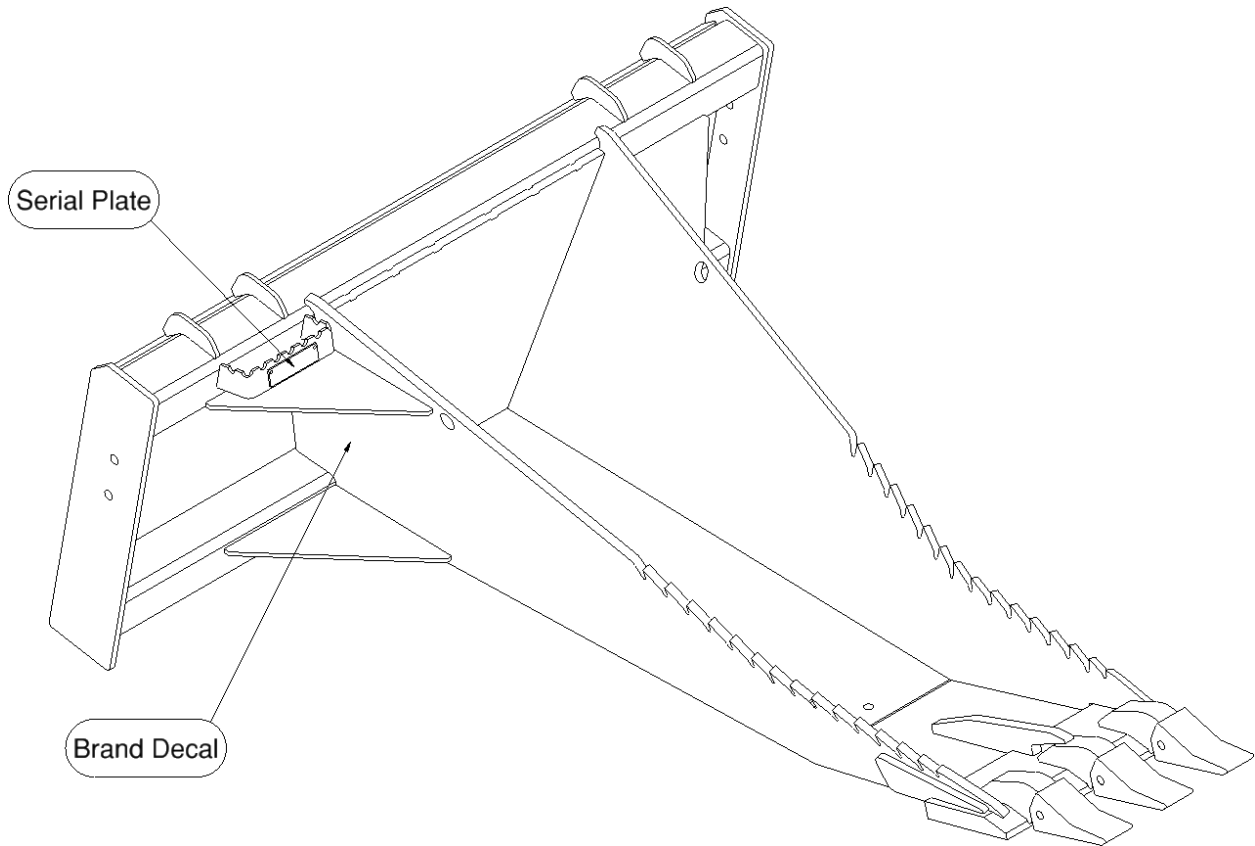

SERIAL NUMBER AND SAFETY DECAL LOCATIONS



Part number: 200001

Location: On top of grapple near cylinder

Quantity: 1



Part number: 203234

Location: Centered on front of grapple

Quantity: 1

Small Brand Decal

Location: On each side of bucket

Quantity: 2

Safety Decals Locations:

The locations of the safety decals are shown. If these decals are missing, damaged, or painted over they must be replaced. Call Quick Attach Attachments LLC (320-759-1551) for replacement decals.

USER'S MOUNTING INSTRUCTIONS

After the initial set-up assembly is completed use the following procedure to mount the attachment to the loader.

⚠ WARNING Coupler wedges or pins must extend through holes in attachment. Levers must be fully down and locked. Failure to secure wedges or pins can allow the attachment to come off and cause injury or death.

1. Use the step, safety treads, and grab handles to get on and off the loader and attachment.



2. Sitting in the operator's seat, lower seat bar (if so equipped) and fasten the seat belt.

3. Drive the loader to the rear of the attachment. Put the loader quick attach coupler into the attachment mounting bracket.

4. Tilt the loader coupler backward a small amount until it is fully engaged in the attachment mounting bracket.



5. Stop the engine and engage the park brake.

6. Secure the coupler locking mechanism that attaches the attachment to the loader.

USER'S MOUNTING INSTRUCTIONS

For Grapple Model Only:

7. Connect the hydraulic quick couplers from the attachment to the loader.

IMPORTANT: Wipe the ends of the hydraulic quick couplers (both lead and loader) with a rag to remove any possible contamination. Contamination can cause hydraulic components to fail and is not covered under warranty.

IMPORTANT: Make sure the quick couplers are fully engaged. If the quick couplers do not fully engage, check to see that the couplers are the same size and brand. Do not force the quick couplers together.

NOTE: See the loader's operator's manual for auxiliary hydraulic specifications and connection instructions.

NOTE: Attachment is shipped with 8FJX (1/2" Female JIC Swivel) fittings on the ends of the lead hoses.

8. Make sure the hoses are properly routed to fit your specific loader. If the hoses are not routed correctly, hoses may get pinched or rub on tires. Be sure to check the hose routing through the full range of intended motion of the attachment before operating it.

More than one routing may be acceptable depending on the loader. Pick the routing that best suits your loader.

IMPORTANT: Proper hose routing is the responsibility of the owner and/or operator. Pinched or stretched hoses are not covered under warranty.

Mounting is now complete and you are ready to use the attachment. Use reverse order of above instructions to dismount the attachment from the loader.

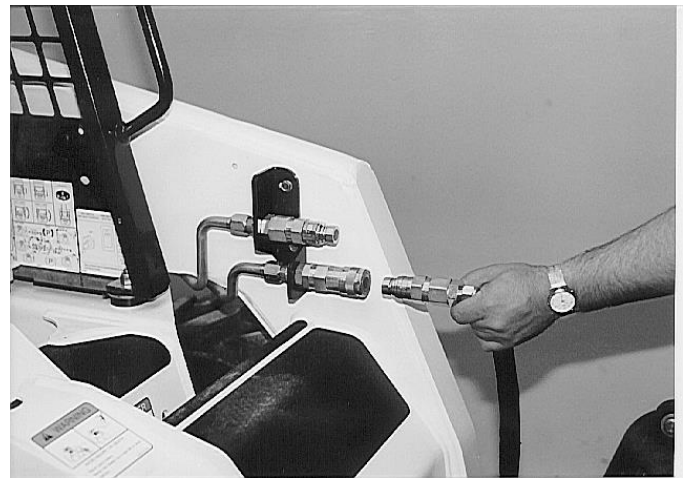

OPERATING INSTRUCTIONS

Call Before You Dig

1-888-258-0808

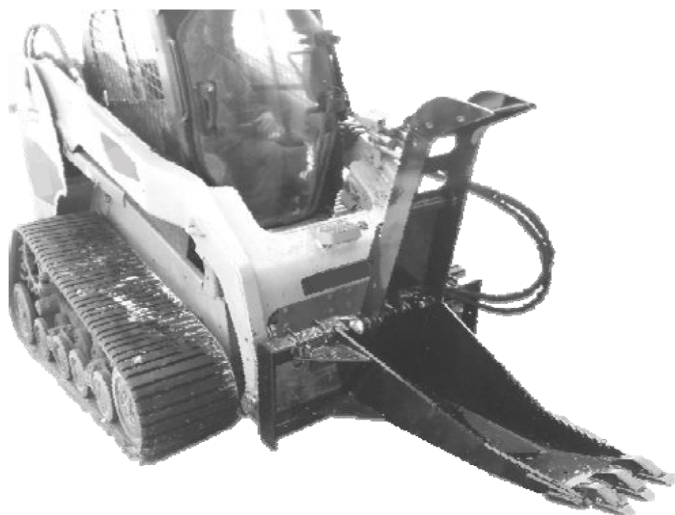

Standard Stump Bucket Operation

The attachment may be used to dig, pry, cut, and carry material. This attachment is designed primarily for digging. Digging out stumps and posts, digging trenches, prying out rocks, and digging small holes in compacted soil are some of the most common tasks. The grapple model enables the operator to secure objects in the bucket, such as for piling up brush, rocks, and trees.

⚠ CAUTION Always close the bucket securely before setting the attachment down on the ground. To avoid serious injury or death from crushing, **NEVER** put any body part near the bucket while open.

1. With the operator in the seat of the loader, the seat belt fastened, and the seat bar lowered (if so equipped), start the engine.
2. On the grapple model, activate the loader's auxiliary hydraulics to open and close the grapple.

⚠ CAUTION If the grappled object becomes unstable or unbalanced, lower the attachment to the ground and repeat the grapping process until the object being lifted remains stable the entire time it is being lifted and moved. Always lower the object to the ground before opening the bucket to release it.

⚠ WARNING To avoid injury or death, do not allow any person to be directly under the attachment or load at any time.

⚠ CAUTION Carry load as low as possible to avoid serious injury or death from tipping or falling load.

OPERATING INSTRUCTIONS

Stump Digging Tips

- Cut trees as high as safely possible, about 4 ft. to 6 ft. above the ground. The higher the stump bucket can safely push on the tree, the easier it will be to loosen and dig out the tree's root ball. Wait to cut up the lower part of the tree until after it is out of the ground. Large stumps that are shorter than 10" can be more difficult to dig out.
- The long, narrow profile and the teeth are designed to dig through compacted soil. However, if possible, wait to dig until after a rain shower because the ground will be softer, allowing the stump to be loosened more easily.
- The difficulty of digging out a stump depends on the size of the tree, how deep the root system is, how much leverage is available at the top of the stump/tree, and the power of the loader being used.
- **Small stumps** (less than 4" diameter) can usually be "popped" out of the ground by driving the end of the bucket underneath the root ball and prying the stump up out of the ground.
- **Medium sized stumps** usually require digging out a hole next to the stump, then approaching the stump with the hole in front of the loader and on the opposite side of the stump. Try to loosen the stump by pushing at the top. Alternate between digging wider/deeper holes and loosening. Dig with the end of the bucket pointed straight down, use the weight of the loader to drive it as deep as possible, and roll the bucket back toward the loader while driving forward to dig deep holes. Prying or lifting will cut through the roots holding the stump in place.
- **Large stumps** (12" diameter or larger) may require a deep hole to be dug all the way around the stump, digging out and cutting as many roots as possible before the stump can be loosened.







ROUTINE MAINTENANCE

⚠ WARNING Lower the attachment to rest flat on the ground, shut down the engine, relieve the hydraulic pressure to the attachment, set the park brake, and wait for all motion to stop before leaving the operator's seat to perform service of any kind.



It is the operator's responsibility to make daily inspections of the loader and attachment for damage, loose bolts, fluid leaks, or anything else that could cause a potential service or safety problem. Preventive maintenance is the easiest and least expensive type of maintenance.

IMPORTANT: Bolts can loosen after initial usage. After the first hour of operation check all bolts.

LUBRICATION

| | | | | |
|---------------------------|---|---|--|--|
| Lubrication Legend |  Multipurpose spray lube |  No. 2 Lithium base gun grease |  Clean engine oil |  Intervals at which lubrication is required |
| | | | | |

Use No. 2 lithium base gun grease when lubricating all attachment grease fittings.

| | |
|--|---|
|  |  |
|--|---|

On grapple model, grease both cylinder zerks [A] and both pivot bushing zerks [B] after every **8 hours** of operation.

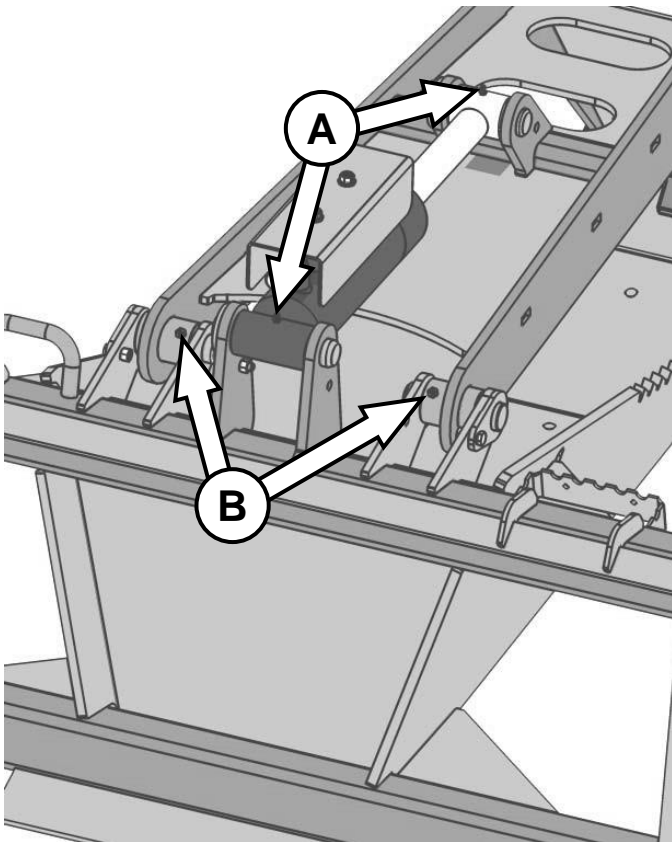

ROUTINE MAINTENANCE

Tooth Replacement

NOTE: When replacing the teeth on the attachment, replace the flex pins as well.

1. Securely block the attachment with the teeth raised slightly off of the ground to allow access.
2. Using a punch and hammer, pound out the flex pin **[A]** and remove the tooth **[B]**. To get the middle tooth out, the punch will need to be fed through the hole in one of the outside tooth holders.
3. Use the reverse order to install new teeth and flex pins. Always install the middle tooth first. Outside pins can more easily be pounded in with just a hammer, no punch, while holding the pin with a pliers.

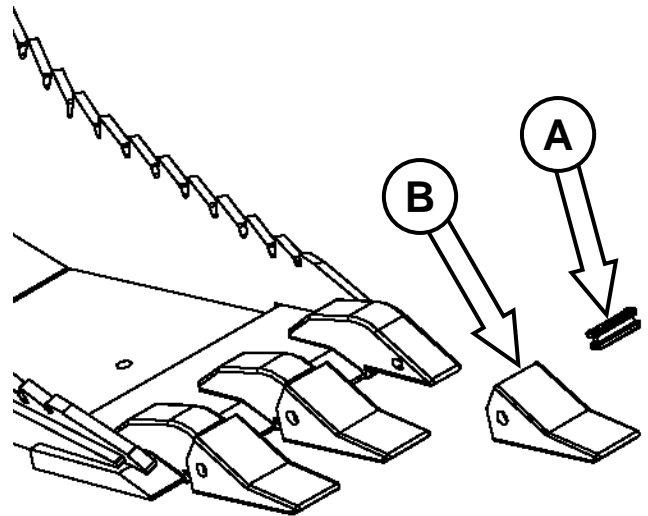

BOLT TORQUE INFORMATION

Torque-Tension Relationships for SAE J429 Grade Bolts

| Nominal Thread Size | SAE J429 Grade 2 | | | SAE J429 Grade 5 | | | SAE J429 Grade 8 | | |
|-------------------------------------|------------------|-------------------|-------------|------------------|-------------------|------------|------------------|-------------------|------------|
| | Clamp Load (lbs) | Tightening Torque | | Clamp Load (lbs) | Tightening Torque | | Clamp Load (lbs) | Tightening Torque | |
| | | K = .15 | K = .20 | | K = .15 | K = .20 | | K = .15 | K = .20 |
| Unified Coarse Thread Series | | | | | | | | | |
| 1/4-20 | 1,300 | 49 in-lbs | 65 in-lbs | 2,000 | 75 in-lbs | 100 in-lbs | 2,850 | 107 in-lbs | 143 in-lbs |
| 5/16-18 | 2,150 | 101 | 134 | 3,350 | 157 | 210 | 4700 | 220 | 305 |
| 3/8-16 | 3,200 | 15 ft-lbs | 20 ft-lbs | 4,950 | 23 ft-lbs | 31 ft-lbs | 6,950 | 32.5 ft-lbs | 44 ft-lbs |
| 7/16-14 | 4,400 | 24 | 30 | 6,800 | 37 | 50 | 9,600 | 53 | 70 |
| 1/2-13 | 5,850 | 36.5 | 49 | 9,050 | 57 | 75 | 12,800 | 80 | 107 |
| 9/16-12 | 7,500 | 53 | 70 | 11,600 | 82 | 109 | 16,400 | 115 | 154 |
| 5/8-11 | 9,300 | 73 | 97 | 14,500 | 113 | 151 | 20,300 | 159 | 211 |
| 3/4-10 | 13,800 | 129 | 173 | 21,300 | 200 | 266 | 30,100 | 282 | 376 |
| 7/8-9 | 11,425 | 125 | 166 | 29,435 | 321 | 430 | 41,550 | 454 | 606 |
| 1-8 | 15,000 | 187.5 | 250 | 38,600 | 482.5 | 640 | 54,540 | 680 | 900 |
| Unified Fine Thread Series | | | | | | | | | |
| 1/4-28 | 1,500 | 55 in-lbs | 75 in-lbs | 2,300 | 85 in-lbs | 115 in-lbs | 3,250 | 120 in-lbs | 163 in-lbs |
| 5/16-24 | 2,400 | 112 | 150 | 3,700 | 173 | 230 | 5,200 | 245 | 325 |
| 3/8-24 | 3,600 | 17 ft-lbs | 22.5 ft-lbs | 5,600 | 26 ft-lbs | 35 ft-lbs | 7,900 | 37 ft-lbs | 50 ft-lbs |
| 7/16-20 | 4,900 | 27 | 36 | 7,550 | 42 | 55 | 10,700 | 59 | 78 |
| 1/2-20 | 6,600 | 41 | 55 | 10,200 | 64 | 85 | 14,400 | 90 | 120 |
| 9/16-18 | 8,400 | 59 | 79 | 13,000 | 92 | 122 | 18,300 | 129 | 172 |
| 5/8-18 | 10,600 | 83 | 110 | 16,300 | 128 | 170 | 23,000 | 180 | 240 |
| 3/4-16 | 15,400 | 144 | 193 | 23,800 | 223 | 298 | 33,600 | 315 | 420 |
| 7/8-14 | 12,610 | 138 | 184 | 32,480 | 355 | 473 | 45,855 | 500 | 668 |
| 1-12 | 16,410 | 205 | 273 | 42,270 | 528 | 704 | 59,670 | 745 | 995 |

Clamp load estimated as 75% of proof load for specified bolts.

Torque values for 1/4 and 5/16 inch series are in inch-pounds. All other torque values are in foot-pounds.

Torque values calculated from formula $T = KDF$

where: $K=0.15$ for "lubricated" conditions

$K=0.20$ for "dry" conditions

PARTS INFORMATION

| ITEM | QTY | PART NO. | DESCRIPTION | STOCK NO. |
|------|-----|---------------|------------------------------------|---------------------------|
| 1 | 1 | 312800 | FRAME STUMP BUCKET W/A | |
| 2 | 1 | 422136 | FRAME STUMP BUCKET EURO W/A | EURO MOUNT |
| 3 | 3 | 312128 | PIN FLEX GR HD | REPLACED 312265 |
| | 3 | 312265 | PIN FLEX | REPLACED BY 312128 |
| 4 | 3 | 312115 | TOOTH GRAPPLE HD | REPLACED 312263 |
| | 3 | 312263 | TOOTH BUCKET PIN ON | OBSOLETE |

PARTS INFORMATION

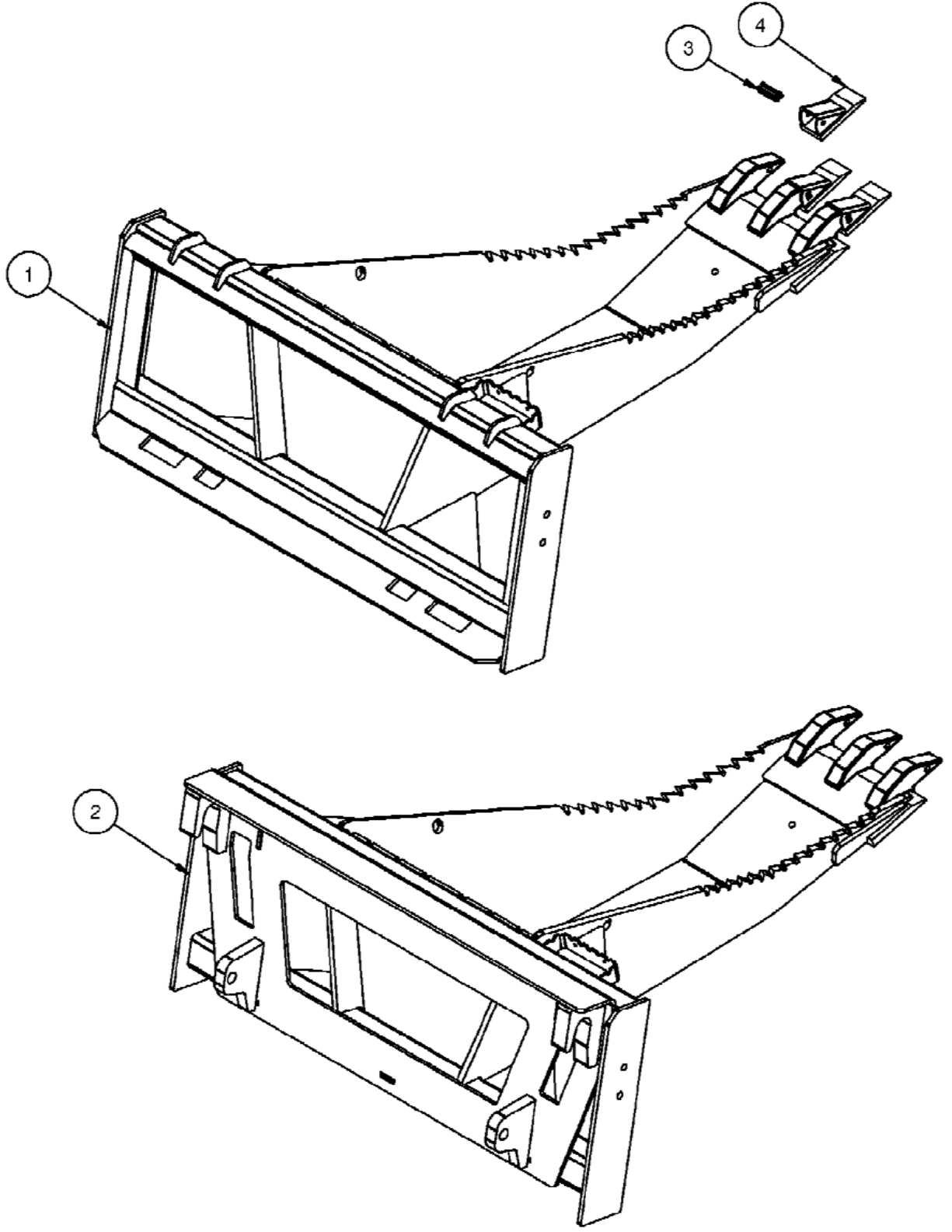

PARTS INFORMATION

| ITEM | QTY | PART NO. | DESCRIPTION | STOCK NO. |
|------|-----|----------|-------------------------------------|---------------------------|
| 1 | 1 | 312802 | FRAME STUMP BUCKET GRAPPLE W/A | |
| 2 | 1 | 422137 | FRAME STUMP BUCKET GRAPPLE EURO W/A | EURO MOUNT |
| 3 | 1 | 312801 | GRAPPLE STUMP BUCKET W/A | |
| 4 | 1 | 312273 | SHIELD CYLINDER 3 X 6 PAINTED | |
| 5 | 3 | 314057 | PIN 1.25 X 4.00 W/A | |
| 6 | 1 | 300104 | PIN 1.25 X 5.125 W/A | |
| 7 | 3 | 312115 | TOOTH GRAPPLE HD | REPLACED 312263 |
| | | 312263 | TOOTH PIN ON | OBSOLETE |
| 8 | 3 | 312128 | PIN FLEX GR HD | REPLACED 312265 |
| | 3 | 312265 | PIN FLEX | REPLACED BY 312128 |
| 9 | 1 | 320089 | ADPT ELB 8MB-6MJ-90 | |
| 10 | 1 | 313267 | ADPT ELB REST. 8MB-6MJ-90-.125 | CYLINDER BASE |
| 11 | 1 | 312826 | HOSE 3/8 X 78 8FJX-6FJX | CLYINDER BASE |
| 12 | 1 | 312825 | HOSE 3/8 X 84 8FJX-6FJX | CYLINDER ROD |
| 13 | 2 | 13107 | BOLT HEX | 3/8 X 1-1/4 NC GR 5 |
| 14 | 2 | 13105 | BOLT HEX | 3/8 X 1 NC GR 5 |
| 15 | 4 | 37212 | NUT REV LOCK | 3/8 NC |
| 16 | 2 | 19929 | BOLT HEX FLANGED | 3/8 X 3/4 NC GR 5 |
| 17 | 1 | 312278 | CYLINDER 3 X 6 B-B | |

PARTS INFORMATION

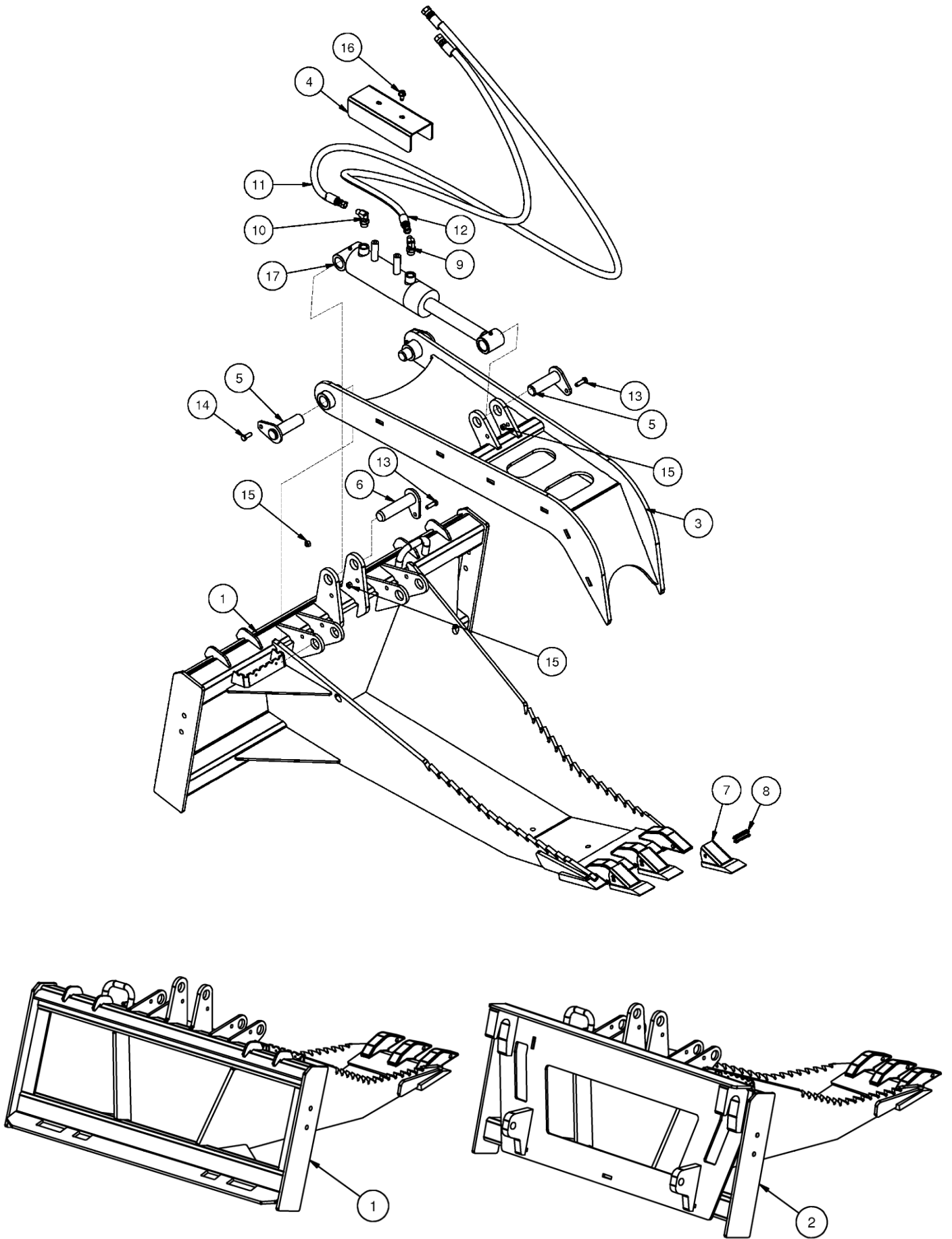

GENERAL SPECIFICATIONS

| Model | Stump Bucket | Stump Bucket with Grapple |
|-------------------|-----------------|---------------------------|
| Overall Width | 45.4" | 45.4" |
| Replaceable Teeth | 3 pin-on teeth | 3 pin-on teeth |
| Grapple Opening | N/A | 50.3" |
| Cutting Edge | 1" x 6" weld-on | 1" x 6" weld-on |
| Cylinder | N/A | 3" x 6", 3000 PSI |
| Operating Weight | 380 lbs. | 520 lbs. |

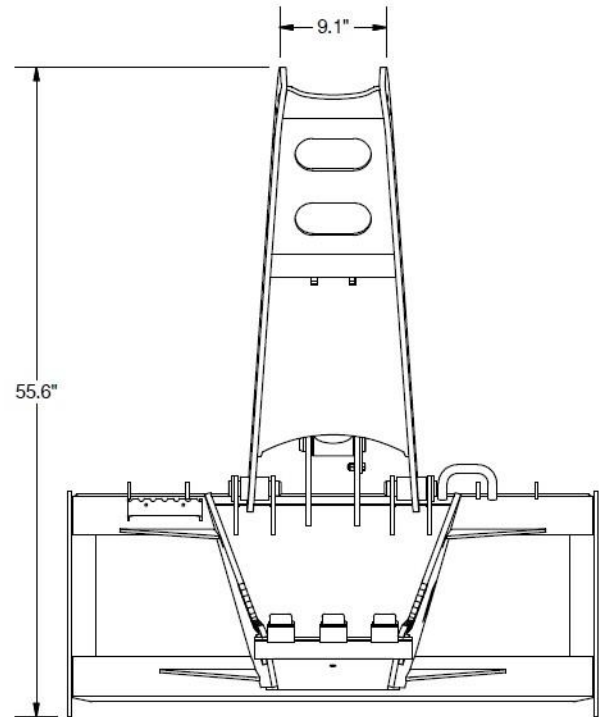
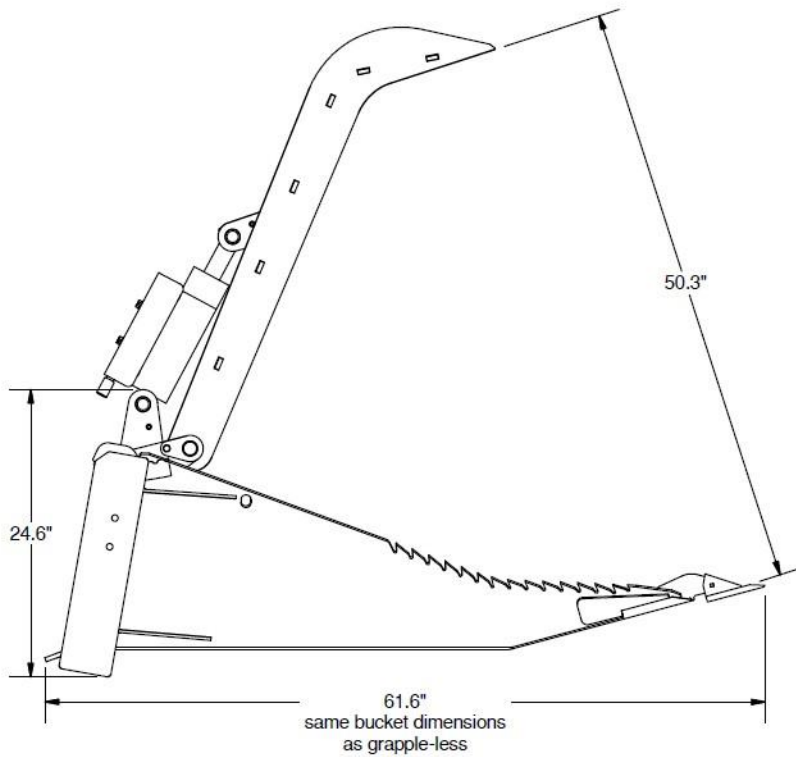
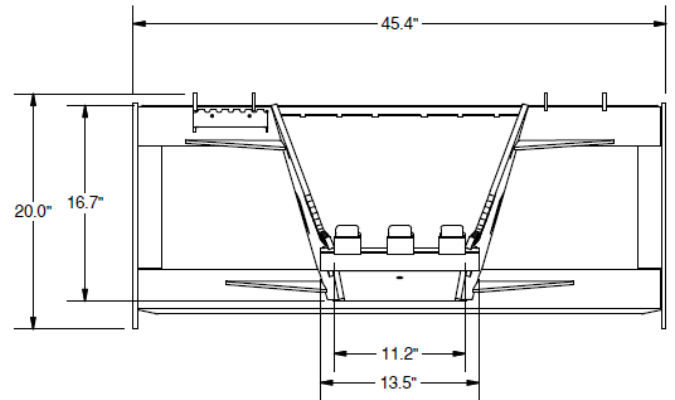
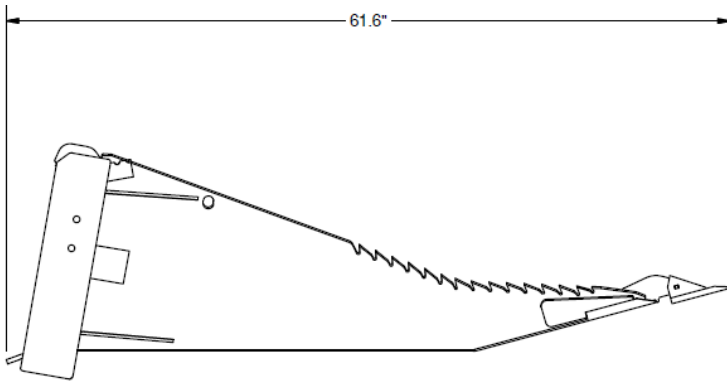

All dimensions are in INCHES.



LIMITED WARRANTY

Quick Attach Attachments LLC warrants each new machine manufactured by us to be free from defects in material and workmanship for a period of twelve (12) months from date of delivery to the original purchaser.

Our obligation under this warranty is to replace free of charge, at our factory or Direct Outlet locations, any part proven defective within the stated warranty time limit.

All parts must be returned freight prepaid and adequately packaged to prevent damage in transit.

This warranty does not cover:

1. New products which have been operated in excess of rated capacities or negligence
2. Misuse, abuse, accidents or damage due to improperly routed hoses
3. Machines which have been altered, modified or repaired in any manner not authorized by our company
4. Previously owned equipment
5. Any ground engaging tools in which natural wear is involved, i.e. tooth tips, cutting teeth, etc
6. Normal maintenance
7. Fork tines
8. Hydraulic motors that have been disassembled in any manner

In no event will the Sales Representative, Direct Outlet, Quick Attach Attachments LLC, or any other company affiliated with it or them be liable for incidental or consequential damages or injuries, including but not limited to the loss of profit, rental or substitute equipment or other commercial loss. Purchaser's sole and exclusive remedy being as provided here in above.

Quick Attach Attachments LLC must receive immediate notification of defect and no allowance will be made for repairs without our consent or approval.

This warranty is in lieu of all other warranties, express or implied by law or otherwise, and there is no warranty of merchantability or fitness purpose.

No agent, employee, or representative of Quick Attach Attachments LLC has any authority to bind Quick Attach Attachments LLC to any warranty except as specifically set forth herein. Any of these limitations excluded by local law shall be deemed deleted from this warranty; all other terms apply.

This warranty may not be enlarged or modified in any manner except in writing signed by an executive officer of Quick Attach Attachments LLC to improve its products whenever it is possible and practical to do so. Quick Attach Attachments LLC reserves the right to make changes and or add improvements at any time without incurring any obligation to make such changes or add such improvements to products previously sold.

Quick Attach Attachments LLC
P.O. Box 128 Alexandria, MN 56308
Phone (320) 759-1551 Fax (320) 759-1590



P/N 312814
Quick Attach Attachments LLC

Date Printed: 6/6/2018

Printed in U.S.A.