

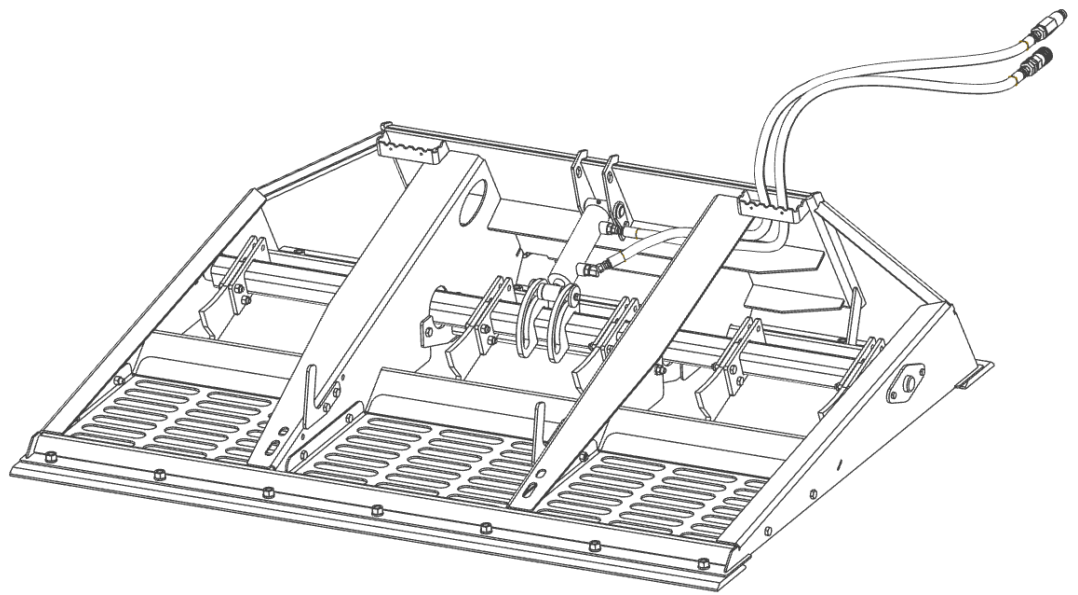

QUICK ATTACH



LAND LEVELER™

LAND PLANER V2 74" / 86"

Operator's Manual

Maintenance & Parts Information



Read this Manual Before Use

TABLE OF CONTENTS

SAFETY	3-4
DECAL INFORMATION	5-6
MOUNTING INSTRUCTIONS	7-8
OPERATING INSTRUCTIONS	9-11
ROUTINE MAINTENANCE	12-14
TORQUE INFORMATION	15
PARTS INFORMATION	16-17
GENERAL SPECS	18
NOTES	19
WARRANTY	20

NOTE: Write your serial number for your attachment in the spaces below. Always refer to this serial number when calling for services parts.

Serial Number

Attachment Dealer

Address

Phone Number

Contact

NOTE: Quick Attach LLC reserves the right to make improvements in design or changes in specifications at any time without notice and without incurring any obligations to install them on units previously sold.

SAFETY

DO NOT use or perform maintenance on this machine until this manual has been read and understood. In addition, read the Operation and Maintenance Manual(s) pertaining to the attachment and the attachment carrier (“Loader”).

The user is responsible for inspecting the machine daily, and for having parts repaired or replaced when continued use of the machine would cause damage, excessive wear to other parts or make the machine unsafe for continued operation.

If an operating procedure, tool device, maintenance or work method not specifically recommended is used; you must satisfy yourself that it is safe for you and others. You must also ensure that the attachment will not be damaged or made unsafe by the procedures you choose.

Quick Attach LLC cannot anticipate every possible circumstance that might involve potential hazard. The safety messages found in this manual and on the machine are therefore not all inclusive

The signal words **CAUTION**, **WARNING**, or **DANGER** are used to indicate hazards.

⚠ CAUTION

Indicates a potentially hazardous situation which, if not avoided, may result in minor or moderate injury.

⚠ WARNING

Indicates a potentially hazardous situation which, if not avoided, could result in death or serious injury.

⚠ DANGER

Indicates a potentially hazardous situation which, if not avoided, will result in death or serious injury.

The word **IMPORTANT** is used in the text when immediate damage will occur due to improper technique or operation.

The word **NOTE** is used to convey information that is out of context with the manual text; special information such as specifications, techniques, reference information, and other information of a supplementary nature.

SAFETY

Improper operation can cause serious injury or death.

PRE-OPERATION

- **NEVER** use this attachment for purposes other than intended.
- Read the operator's manual for the "Skid Steer Loader". **NEVER** allow untrained people to operate.
- Operating instructions must be given to everyone before operating this machine and at least once a year thereafter in accordance with OSHA regulations.
- **NEVER** exceed the maximum recommended input power or speed specifications for the attachment. Over-powering or over-speeding the attachment may cause personal injury and/or machine damage.
- Keep all shields, guards, and covers in place.
- Do not modify equipment or add attachments that are not approved by Quick Attach LLC.
- Use adequate safety warning lights and devices as required by local regulations. Obey all local laws and regulations regarding machine operation on public property.

OPERATION

- Always wear eye protection that meets z87.1 or use with a loader enclosure that provides similar protection.
- Hydraulic connections may be hot after use. Use gloves if connecting or disconnecting after use.
- Check and be sure all operating controls are in neutral before starting the engine.
- Keep people away from loader and attachment when in use. This attachment send objects flying and has rotating parts. **NEVER** direct discharge toward people - rocks and debris can be thrown.

OPERATION (continued)

- Depending on how this attachment is used, dust can be created. Prolonged exposure to dust can cause chronic and acute health problems. A NIOSH-approved respirator may be required.
- **NEVER** operate near embankments or terrain that is so steep that rollover could occur.
- Always stay in the operator position when using the attachment.
- Before leaving the operators position, disengage hydraulic drive, lower the attachment to rest flat on the ground, stop engine, set park brake, and wait for all motion to stop.
- **NEVER** place hands in the discharge area or clear debris while engine is running.

AVOID HIGH PRESSURE FLUIDS HAZARD

- Escaping fluid under pressure can penetrate the skin causing serious injury.
- Avoid the hazard by relieving the pressure before disconnecting hydraulic lines.
- Use a piece of paper or cardboard, **NOT BODY PARTS**, to check for suspected leaks. Wear protective gloves and safety glasses or goggles when servicing or performing maintenance on hydraulic systems.
- If an accident occurs, see a doctor immediately. Any fluid injected into the skin must be surgically removed within a few hours or gangrene may result.

MAINTENANCE

- **NEVER** make adjustments, lubricate, clean, or perform any service on the machine while it is in operation.
- Make sure the attachment is serviced on a daily basis. Improper maintenance can cause serious injury or death in addition to damage to the attachment and/or your equipment.

DECAL INFORMATION

Serial Number Location:

It is important to refer to the serial number of your attachment when making repairs or ordering parts. Early or later models (identification made by serial number) may use different parts, or it may be necessary to use different procedures in doing a specific operation. Please see below for Serial Plate location.

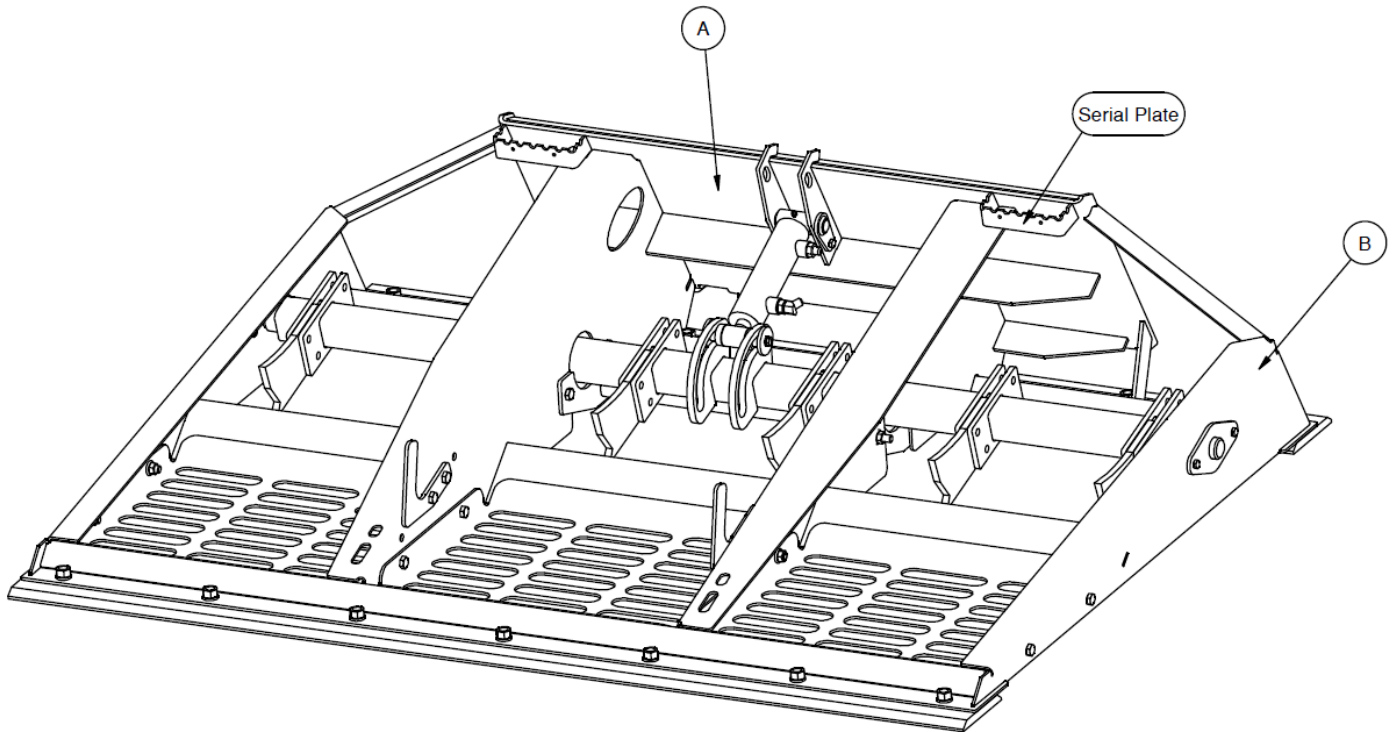

DECAL INFORMATION

(A)



Part number: 200001
Location: Left of cylinder mount
Quantity: 1

(B)



Brand Decal: Large
Location: Each end of frame
Quantity: 2

Safety Decals Locations:

The locations of the safety decals are shown. If these decals are missing, damaged, or painted over they must be replaced. Call Quick Attach LLC (218-435-4045) for replacement decals.

MOUNTING INSTRUCTIONS

After the initial set-up assembly is completed use the following procedure to mount the attachment to the loader for user operation.

⚠ WARNING

Coupler wedges or pins must extend through holes in attachment. Levers must be fully down and locked. Failure to secure wedges or pins can allow the attachment to come off and cause injury or death.

1. Use the step, safety treads, and grab handles to get on and off the loader and attachment.
2. Sitting in the operator's seat, lower seat bar (if so equipped) and fasten the seat belt.
3. Drive the loader to the rear of the attachment. Put the loader quick attach coupler into the attachment mounting bracket.
4. Tilt the loader coupler backward a small amount until it is fully engaged in the attachment mounting bracket.
5. Stop the engine and engage the park brake.
6. Secure the coupler locking mechanism that attaches the attachment to the loader.
7. Connect the hydraulic quick couplers from the attachment to the loader.



IMPORTANT: Wipe the ends of the hydraulic quick couplers (both lead and loader) with a rag to remove any possible contamination. Contamination can cause hydraulic components to fail and is not covered under warranty.

IMPORTANT: Make sure the quick couplers are fully engaged. If the quick couplers do not fully engage, check to see that the couplers are the same size and brand. Do not force the quick couplers together.

MOUNTING INSTRUCTIONS

NOTE: See the loader's operator's manual for auxiliary hydraulic specifications and connection instructions.

NOTE: Attachment is shipped with 8FJX Female JIC Swivel fittings on the ends of the lead hoses.

8. Connect the attachment wire harness (if equipped) to the loader's wire harness receptacle.

9. Make sure hoses and harness are routed properly to fit your specific loader. If the hoses are not routed properly, hoses may get pinched or rub on tires. Be sure to check the hose routing through the full range of intended motion of the attachment before operating it.

IMPORTANT: Proper hose and harness routing is the responsibility of the owner and/or operator. Pinched or stretched hoses and harnesses are not covered under warranty.

NOTE: More than one routing may be acceptable depending on the loader. Pick the routing that best suits your loader.

NOTE: Mounting is now complete and the attachment is ready for operation. Use reverse order of above instructions to dismount the attachment from the loader.



OPERATING INSTRUCTIONS

With the operator in the seat of the loader, seat belt fastened, and seat bar lowered (if so equipped), start the engine.

Cutting the Ground

1. Raise the loader lift arms and tilt the attachment to the desired angle.
2. If operating while moving forward, lower the loader lift arms until the front cutting edge enters the ground.
3. If operating in reverse, lower the loader lift arms until the rear cutting edge enters the ground.
4. Use the loader tilt and lift functions to adjust cutting depth and increase traction. Keep the digging depth even in order to obtain the desired grade angle.

Using the Scarifying Teeth

When the scarifying teeth are engaged, they break up hard or compacted soil while the cutting edge levels the soil.

1. Raise the attachment slightly above the ground and activate the auxiliary hydraulics. The scarifying teeth will lower via gravity into the operating position.

IMPORTANT: The scarifying teeth are designed to be used in the fully lowered position. If the scarifying teeth are used when not fully lowered, damage may occur to the cylinder, cylinder mount, or frame. When not using the scarifying teeth, make sure they are fully raised.

NOTE: The scarifying tooth bar may be stiff when new and not fully lower at first. The tooth bar will operate more freely after an initial break-in period.

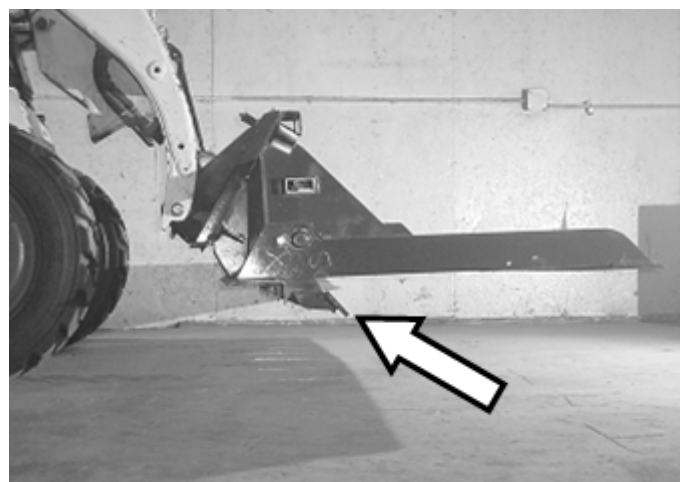
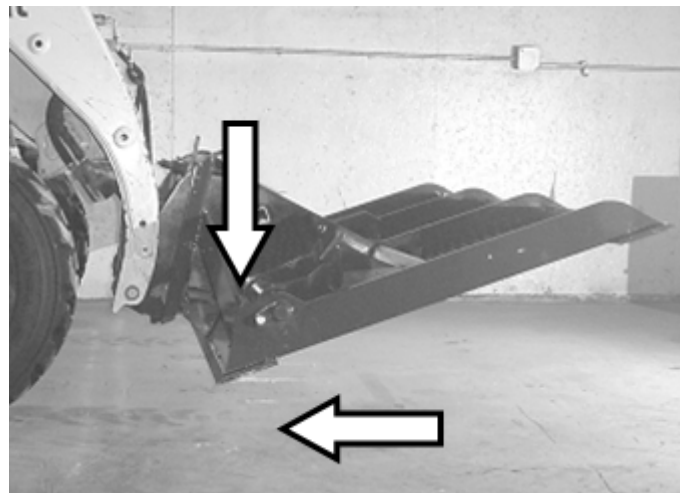
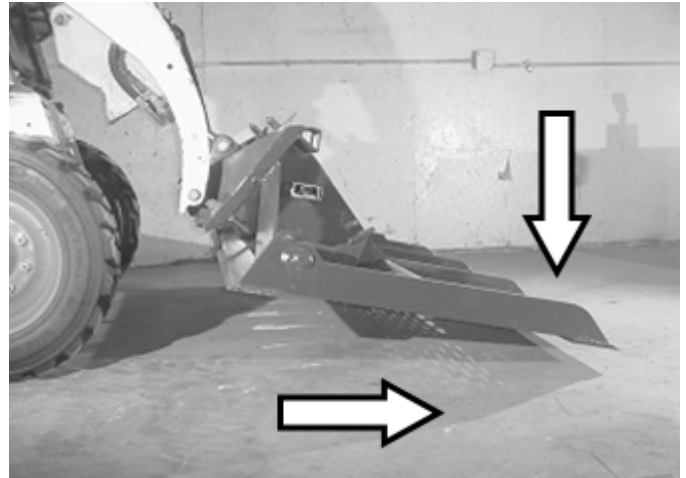

OPERATING INSTRUCTIONS

Lower the loader lift arms until the rear cutting edge is on the ground. Control the digging depth by raising or lowering the front cutting edge.



Leveling the Ground

1. To level the ground, raise the loader lift arms and position the attachment at the desired angle.
2. If operating while moving forward tilt the attachment so that there is more pressure on the rear cutting edge than there is on the front cutting edge.
3. If operating in the reverse direction, tilt the attachment so that there is more pressure on the front cutting edge than there is on the rear cutting edge.
4. When operating in the forward direction, the optional expanded metal grates will allow the soil to fall through, but will catch and hold rocks and debris.

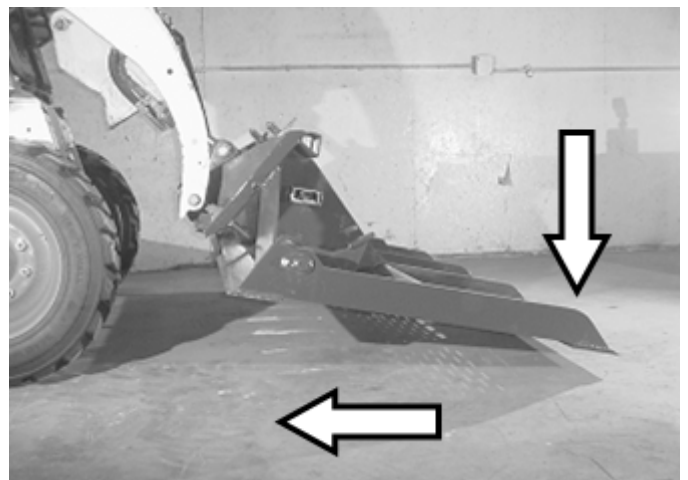
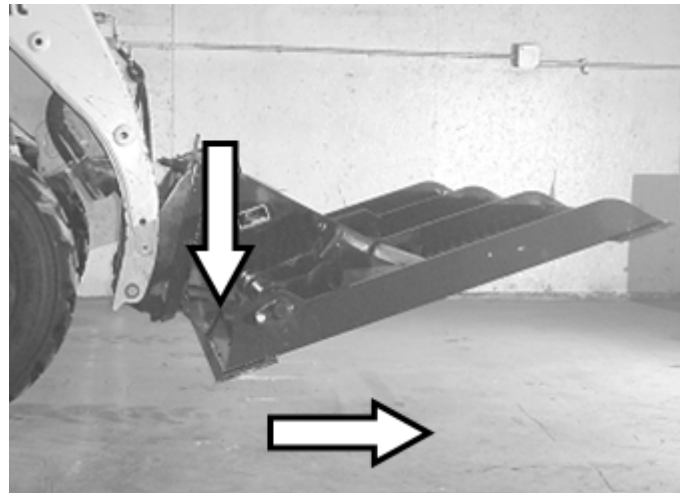

OPERATING INSTRUCTIONS

Scarifier operating direction

Scarify in forward direction

1. Teeth should be bolted in facing forward
2. Make sure hardstop tube is towards the rear of the scarifier.
3. The scarifier frame does not need to be removed, only the teeth and hardstop need to be moved

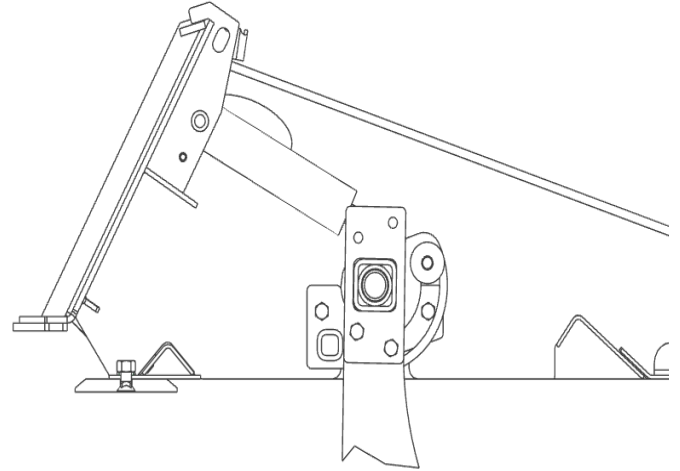

Scarify in backward direction

4. Teeth should be bolted in facing towards the rear
5. Make sure hardstop tube is towards the front of the scarifier.
6. The scarifier frame does not need to be removed, only the teeth and hardstop need to be moved

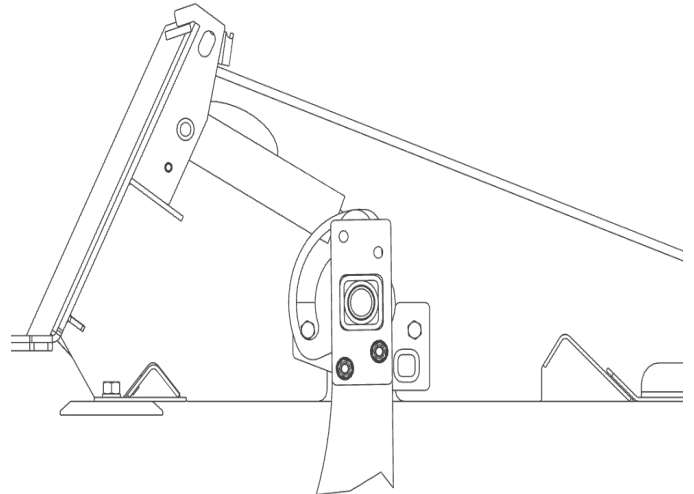

ROUTINE MAINTENANCE

⚠ WARNING

Lower the attachment to rest flat on the ground, shut down the engine, relieve the hydraulic pressure to the attachment, set the park brake, and wait for all motion to stop before leaving the operator's seat to perform service of any kind.

It is the operator's responsibility to make daily inspections of the loader and attachment for damage, loose bolts, fluid leaks, or anything else that could cause a potential service or safety problem. Preventive maintenance is the easiest and least expensive type of maintenance.

IMPORTANT: Bolts can loosen after initial usage. After the first hour of operation check all bolts.

Scarifying Teeth

Inspect the scarifying teeth before each use. If the teeth get worn to the point of replacement, the teeth may be replaced by removing and replacing entire individual tooth.

Tooth Mount Removal

NOTE: It is recommended to perform this task with two persons and to use either a hoist or loader to move the attachment.

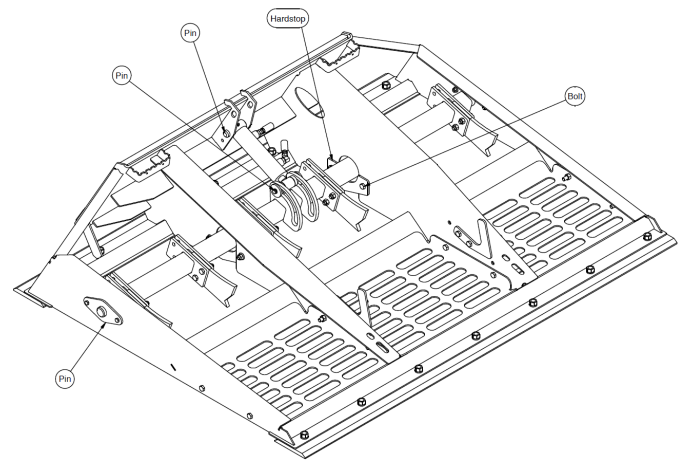

1. Position the attachment flat on the ground, and make sure the attachment hydraulic couplers are disconnected from the loader.
2. Loosen the cylinder mounting bolts for the pins and remove the cylinder. Make sure the cylinder is secured out of the way.
3. Loosen the bolts securing the tooth mount hardstop and remove.
4. Loosen the bolts securing the tooth mount pins and remove the two pins.
5. Using either a hoist or the loader, lift the main frame up and away from the tooth mount.

ROUTINE MAINTENANCE

Tooth Mount Installation

1. Secure the cylinder pivot to the new tooth mount.
2. Position the new tooth mount on the ground in the lowered position.
3. Carefully lower the main frame onto the new tooth mount. Line up the holes for the tooth mount pins, and install the pins, nuts, and bolts.
4. Position the attachment flat on the ground with the tooth mount in the raised position as shown.
5. Install the tooth mount support plates and secure with bolts.
6. Install the cylinder on the frame and tooth mount cylinder pivot, and tighten cylinder mount bolts.

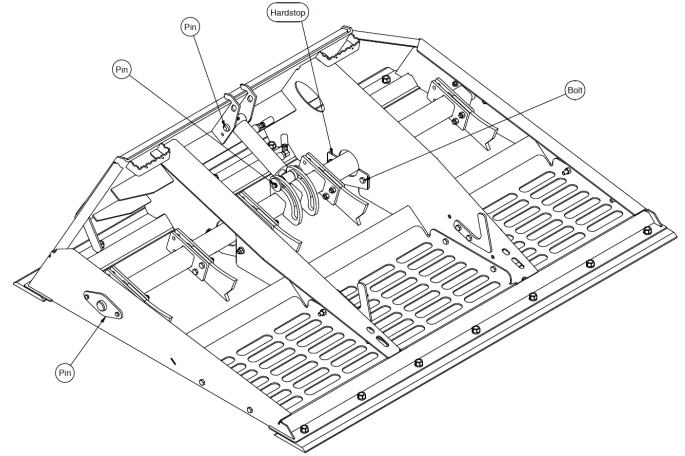

ROUTINE MAINTENANCE

Metal Grate Removal and Installation

1. Position the attachment with the front off the ground and the rear on the ground, engage the park brake, and shut off the loader engine.
2. To remove the metal grates, remove the bolts on the sides of each grate.
3. Lift up on the of the grate then slide it out the bottom and remove it from the frame.
4. To install metal grates, use reverse order of above instructions.

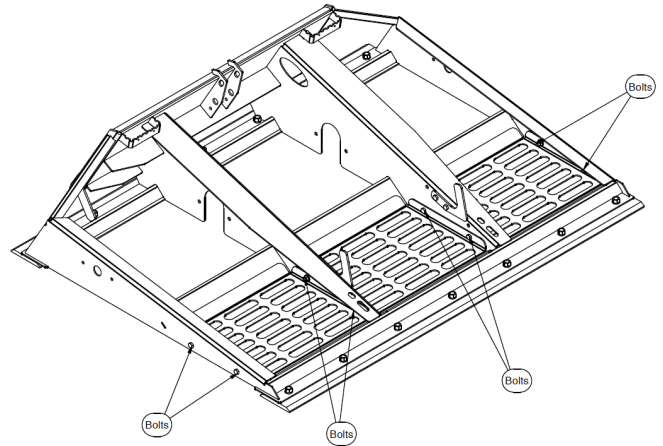

Bucket Storage and Transfer

⚠ WARNING

Before moving your equipment with the bucket stored on top of the land planer, ensure it is safely secured with straps or tie down. With out doing so can lead to serious injury or death.

1. This attachment is equipped with bumpers that allow you to store a dirt bucket on top. Unhook from the planer and carefully set the buck from either the rear or front of the planer for easy storage or transferring locations.

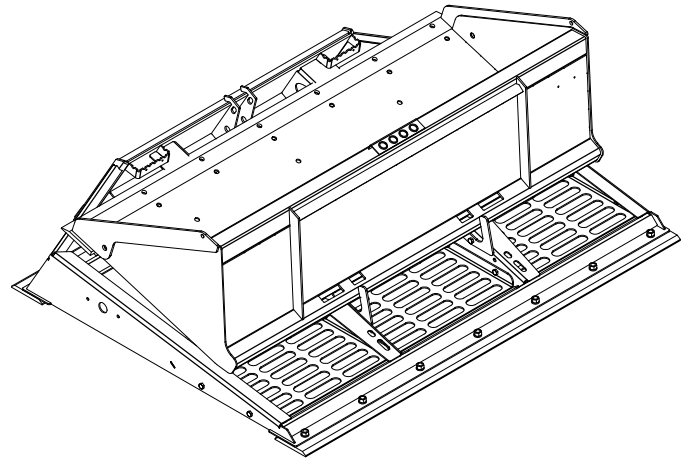

TORQUE INFORMATION

Torque-Tension Relationships for SAE J429 Grade Bolts

Nominal Thread Size	SAE J429 Grade 2			SAE J429 Grade 5			SAE J429 Grade 8		
	Clamp Load (lbs)	Tightening Torque		Clamp Load (lbs)	Tightening Torque		Clamp Load (lbs)	Tightening Torque	
		K = .15	K = .20		K = .15	K = .20		K = .15	K = .20
Unified Coarse Thread Series									
1/4-20	1,300	49 in-lbs	65 in-lbs	2,000	75 in-lbs	100 in-lbs	2,850	107 in-lbs	143 in-lbs
5/16-18	2,150	101	134	3,350	157	210	4700	220	305
3/8-16	3,200	15 ft-lbs	20 ft-lbs	4,950	23 ft-lbs	31 ft-lbs	6,950	32.5 ft-lbs	44 ft-lbs
7/16-14	4,400	24	30	6,800	37	50	9,600	53	70
1/2-13	5,850	36.5	49	9,050	57	75	12,800	80	107
9/16-12	7,500	53	70	11,600	82	109	16,400	115	154
5/8-11	9,300	73	97	14,500	113	151	20,300	159	211
3/4-10	13,800	129	173	21,300	200	266	30,100	282	376
7/8-9	11,425	125	166	29,435	321	430	41,550	454	606
1-8	15,000	187.5	250	38,600	482.5	640	54,540	680	900
Unified Fine Thread Series									
1/4-28	1,500	55 in-lbs	75 in-lbs	2,300	85 in-lbs	115 in-lbs	3,250	120 in-lbs	163 in-lbs
5/16-24	2,400	112	150	3,700	173	230	5,200	245	325
3/8-24	3,600	17 ft-lbs	22.5 ft-lbs	5,600	26 ft-lbs	35 ft-lbs	7,900	37 ft-lbs	50 ft-lbs
7/16-20	4,900	27	36	7,550	42	55	10,700	59	78
1/2-20	6,600	41	55	10,200	64	85	14,400	90	120
9/16-18	8,400	59	79	13,000	92	122	18,300	129	172
5/8-18	10,600	83	110	16,300	128	170	23,000	180	240
3/4-16	15,400	144	193	23,800	223	298	33,600	315	420
7/8-14	12,610	138	184	32,480	355	473	45,855	500	668
1-12	16,410	205	273	42,270	528	704	59,670	745	995

Clamp load estimated as 75% of proof load for specified bolts.

Torque values for 1/4 and 5/16 inch series are in inch-pounds. All other torque values are in foot-pounds.

Torque values calculated from formula $T = KDF$

where: $K=0.15$ for "lubricated" conditions

$K=0.20$ for "dry" conditions

PARTS INFORMATION

ITEM	QTY	PART NO.	DESCRIPTION	STOCK NO
1	1	343200	FRAME LP 74 W/A	74" MODEL ONLY
1	1	343201	FRAME LP 86 W/A	86" MODEL ONLY
2	1	343202-02	SCARIFIER 74 W/A	74" MODEL ONLY
2	1	343203-02	SCARIFIER 86 W/A	86" MODEL ONLY
3	2	318430	CUTTING EDGE B 74 DB	74" MODEL ONLY
3	2	318474	CUTTING EDGE B 86 DB	86" MODEL ONLY
4	1	400074	CYLINDER 2 X 4 W/BUSHINGS	
5	REF	343254	BRKT GRATE 24	74" - QTY 3, 86" - QTY 1
5	REF	343255	BRKT GRATE 30	86" - QTY 2
6	6	343218-02	TOOTH SCARIFIER	
7	1	400041	PIN 1 X 4 W/A	
8	7	13105	BOLT 3/8 X 1 NC GR5	
9	2	343236-02	PLATE BUCKET HOLDER	
10	2	343239	PIN 1.5 X 6 W/A Z	
11	14	22663	BOLT PLOW 5/8 X 1-1/2 NC GR5	
12	14	33630	WASHER SPLIT LOCK	
13	14	36314	NUT HEX FULL 5/8 NC GR 5 Z	
14	4	15207	BOLT 1/2 X 1-1/4 NC GR 8 YZ	
15	4	0167011	NUT TOP LOCK FLNG 1/2 NC GR G (GR8)	
16	5	0166988	NUT FLG TOP-LOCK	
17	1	343232	WELD HARD STOP	
18	2	343224	PLATE PIN WASHER Z	
19	2	103880	WASHER SPLIT LOCK	
20	1	343223	PIN SHAFT 1 X 4.5 W/H Z	
21	2	343247	BUSH 1.5 X 1.06 X 0.45 Z	
22	1	201925	ADPT STR 8MB-6MJ	
23	1	300274	ADPT ELB 8MB-6MJ-45	
24	12	15211	BOLT 1/2 X 2 NC GR 8 YZ	
25	27	37214	NUT HEX 1/2 REV LOCK	
26	12	15209	BOLT 1/2 X 1-1/2 NC GR 8 YZ	
27	2	343227	HOSE 3/8 x 72" 6FJX-8FJX	
28	1	343231	KIT HOSE LANDPLANER V2	

PARTS INFORMATION

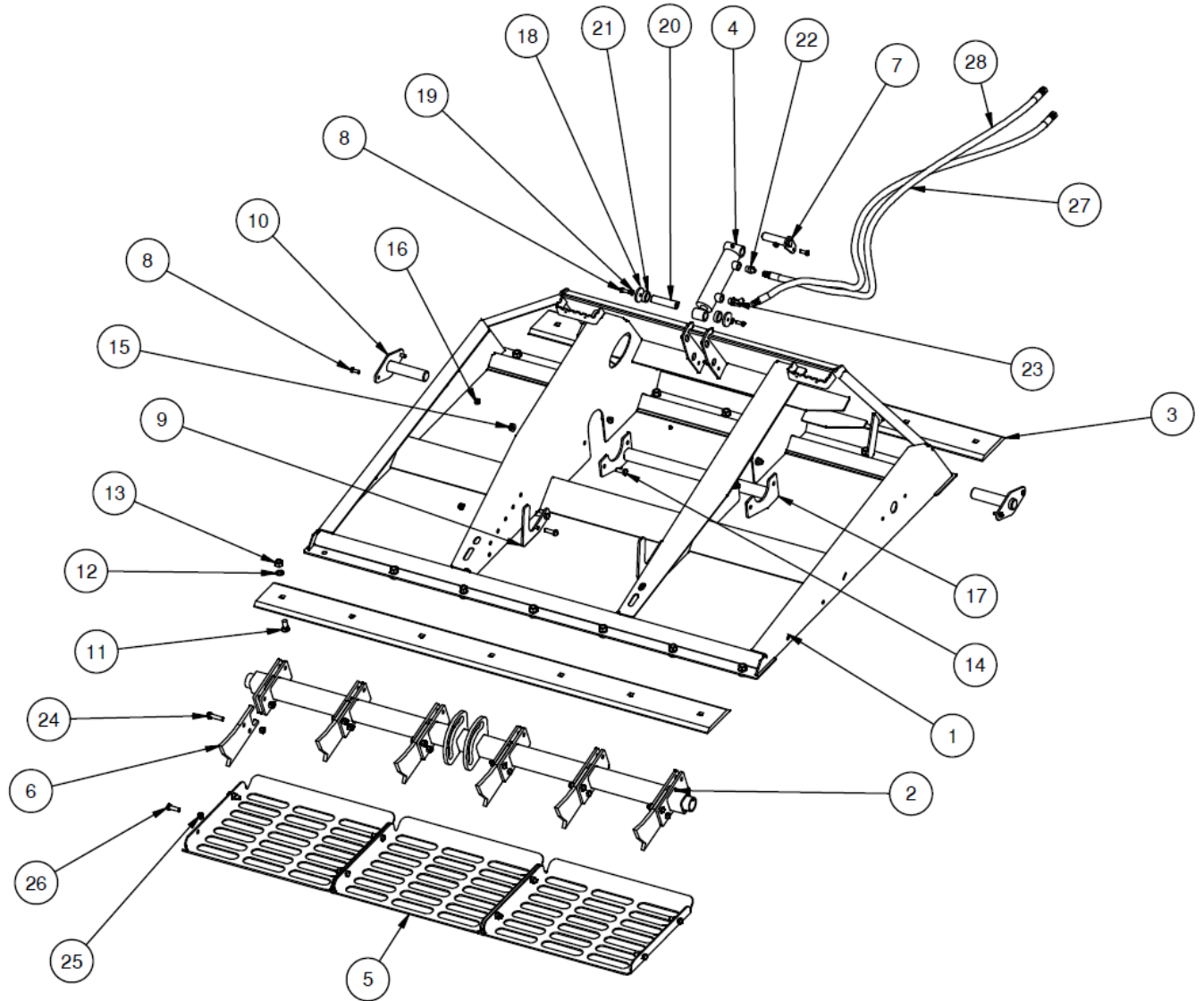

GENERAL SPECS

Model	Land Planer V2 74	Land Planer V2 86
Working Width	74	86
Cutting Edge	5/8" x 6" DB (2)	5/8" x 6" DB (2)
Operating Weight (standard)	514 lbs	562 lbs
Scarifying Teeth	1/2" (6)	1/2" (6)
Scarifying Teeth Depth	3-5/8"	3-5/8"
Operating Weight (w/ scarifying teeth)	660 lbs	708 lbs

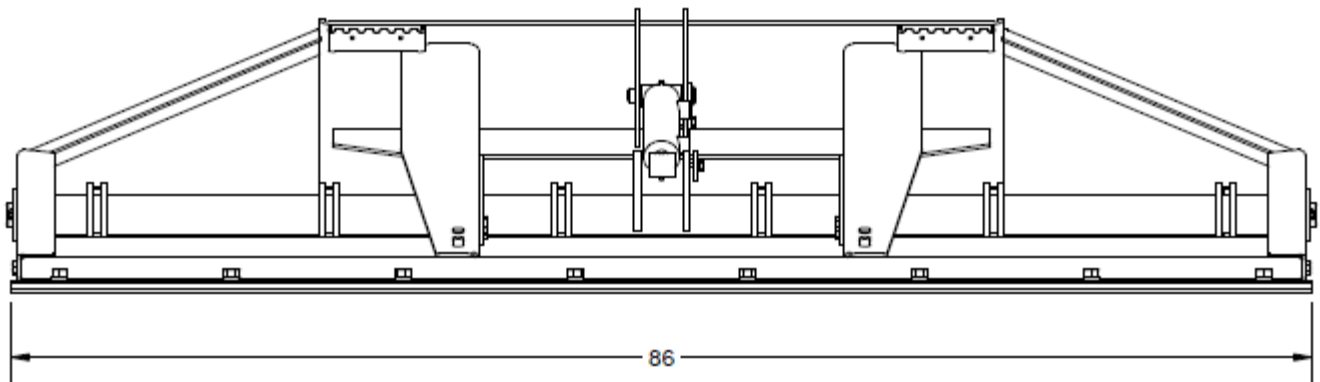
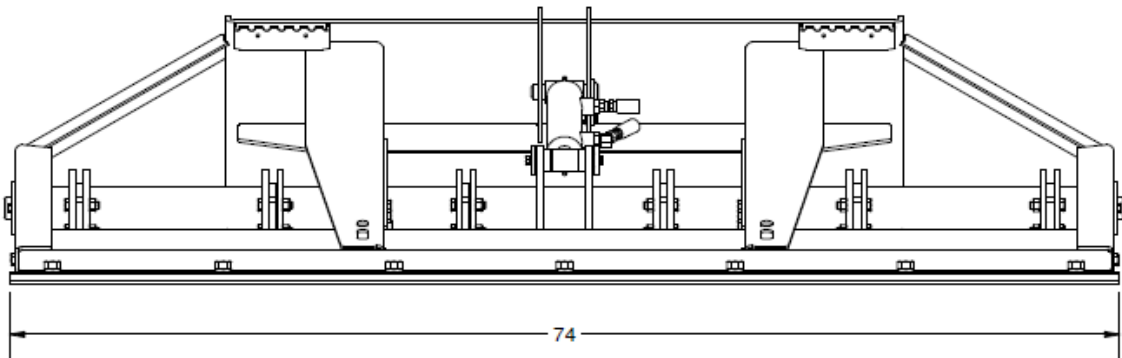
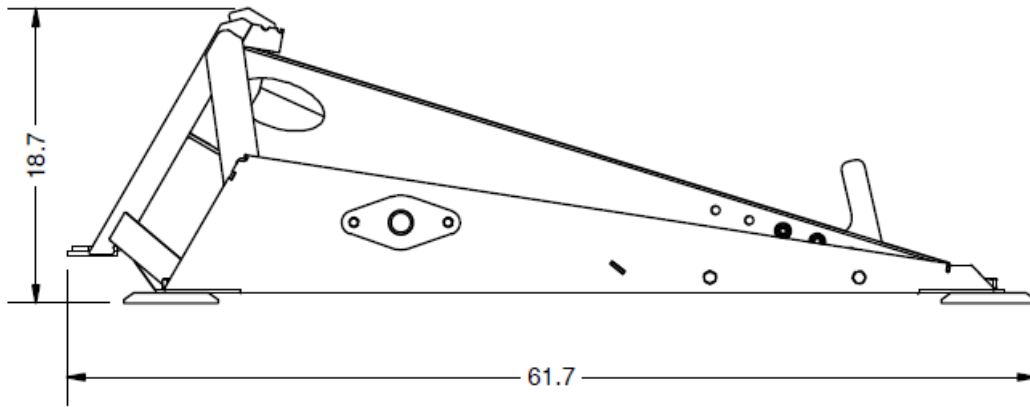

All dimensions are in INCHES.



LIMITED WARRANTY

Quick Attach Attachments, LLC warrants each new machine manufactured by us to be free from defects in material and workmanship for a period of twenty-four (24) months from date of delivery to the original purchaser.

Our obligation under this warranty is to replace free of charge, at our factory or Direct Outlet locations, any part proven defective within the stated warranty time limit.

All parts must be returned freight prepaid and adequately packaged to prevent damage in transit.

This warranty does not cover:

1. New products which have been operated in excess of rated capacities or negligence
2. Misuse, abuse, accidents or damage due to improperly routed hoses
3. Machines which have been altered, modified or repaired in any manner not authorized by our company
4. Previously owned equipment
5. Any ground engaging tools in which natural wear is involved, i.e. tooth tips, cutting teeth, etc
6. Normal maintenance
7. Fork tines
8. Hydraulic motors that have been disassembled in any manner

In no event will the Sales Representative, Direct Outlet, Quick Attach Attachments, LLC, or any other company affiliated with it or them be liable for incidental or consequential damages or injuries, including but not limited to the loss of profit, rental or substitute equipment or other commercial loss. Purchaser's sole and exclusive remedy being as provided here in above.

Quick Attach Attachments, LLC must receive immediate notification of defect and no allowance will be made for repairs without our consent or approval.

This warranty is in lieu of all other warranties, express or implied by law or otherwise, and there is no warranty of merchantability or fitness purpose.

No agent, employee, or representative of Quick Attach Attachments, LLC has any authority to bind Quick Attach Attachments, LLC to any warranty except as specifically set forth herein. Any of these limitations excluded by local law shall be deemed deleted from this warranty; all other terms apply.

This warranty may not be enlarged or modified in any manner except in writing signed by an executive officer of Quick Attach Attachments, LLC to improve its products whenever it is possible and practical to do so. Quick Attach Attachments, LLC reserves the right to make changes and or add improvements at any time without incurring any obligation to make such changes or add such improvements to products previously sold.

Quick Attach Attachments, LLC
P.O. Box 128 Alexandria, MN 56308
Phone (320) 759-1551
Fax (320) 759-1590

